



# County of Faribault

## Drainage Department

### INFORMATIONAL MEETING NOTIFICATION

August 11<sup>th</sup>, 2021

System: Faribault County Judicial Ditch #13 Branch B Watershed & County Ditch #35  
Location: Rome Township Sections 9-11, 13-15, 23-24;  
Seely Township Sections 17-20, 30

RE: Redetermination of Benefits Informational Meeting

Dear Landowner:

There will be an informational meeting held on **Thursday, September 2<sup>nd</sup>, 2021, at 1:00 pm at the Golden Bubble** (11575 State Highway 22 Wells, Minnesota 56097) on Faribault County Judicial Ditch #13 Branch B (JD13F Br B) and County Ditch #35 (CD35). A redetermination of benefits and damages was ordered for both systems, due to the benefits not reflecting reasonable present-day land values and change in the benefited area. JD13F watershed is very large with smaller watersheds within it (like CD35). The Faribault County Drainage Authority is proposing to divide the JD13F watershed into 4 systems and combine the small watersheds within it (see enclosed map) for increased efficiency and clarity in administrating and maintaining the systems. This meeting will cover the benefit and damage values and proposed watershed combinations and divisions.

Due to the pandemic with COVID-19, landowners can join this meeting 1 of the following 3 ways.

1. In person at the Golden Bubble (11575 State Highway 22 Wells, Minnesota 56097) **\*Map on Back**
2. By phone/call-in
3. By Zoom (internet meeting)

If you would like to join the meeting via Zoom you will need a computer, internet, microphone, and speakers. If you do not have a microphone built into your computer, you can call in as well to be able to hear and talk. **If you would like to join via Zoom and/or phone/call-in, please contact the Drainage Department by phone 507-526-2388 or email [sara.hauskins@co.faribault.mn.us](mailto:sara.hauskins@co.faribault.mn.us) by September 1<sup>st</sup>, 2021, for information needed.**

The informational meeting is to discuss the benefit and damage values and get landowner feedback and concerns. The Viewers will be available for questions at the meeting. If you have questions or concerns, please contact the Faribault County Drainage Department at the office 507-526-2388 or by email [merissa.lore@co.faribault.mn.us](mailto:merissa.lore@co.faribault.mn.us).

Sincerely,

Merissa Lore  
Drainage Manager

#### Board of Commissioners/ Drainage Authority

Drainage Staff  
415 S. Grove St., Suite 8  
Blue Earth, MN 56013  
(507) 526-2388  
Fax: (507) 526-2508

District 1:  
John Roper  
18 Elm Blvd.  
Blue Earth, MN 56013  
(507) 526-2710

District 2:  
Greg Young  
35719 150<sup>th</sup> St.  
Winnebago, MN 56098  
(507) 526-3420

District 3:  
Bill Groskreutz, Jr.  
36 4<sup>th</sup> Ave. SW  
Wells, MN 56097  
(507) 553-3518

District 4:  
Tom Loveall  
39290 200<sup>th</sup> St.  
Winnebago, MN 56098  
(507) 854-3300

District 5:  
Bruce Anderson  
50156 110<sup>th</sup> St.  
Bricelyn, MN 56014  
(507) 993-4934

Darren Esser  
Auditor/Treasurer/Coordinator  
415 North Main St.  
Blue Earth, MN 56013  
(507) 526-6211  
[www.co.faribault.mn.us](http://www.co.faribault.mn.us)

# Golden Bubble

The Golden Bubble is conveniently located off Interstate 90 at exit 138 on Minnesota Highway 22. The address is 11575 State Highway 22, Wells MN 56097.

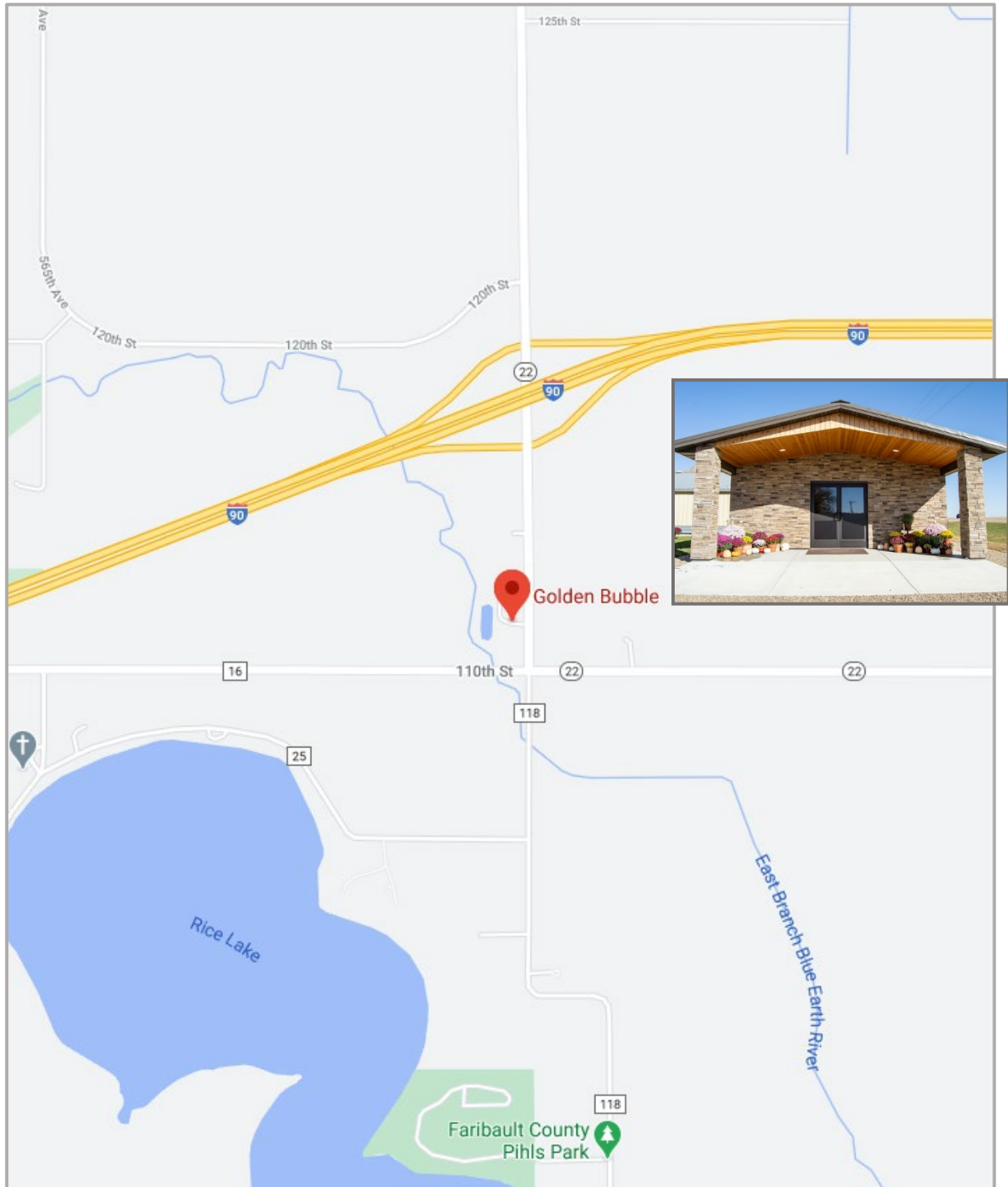

TO: Landowners on Faribault County JD-13 Branch B

RE: Landowner informational meeting

**Thursday, September 2, 2021 1:00 PM**  
**The Golden Bubble**  
**11575 State Highway 22**  
**Wells, Minnesota 56097**  
**507-526-2388**

The Faribault County Drainage Authority ordered a Redetermination of Benefits of Faribault County JD-13 Branch B. Viewers have been appointed to determine the benefits and damages to all property within the watershed of JD-13 Branch B. The redetermination of benefits and damages is the process in drainage law where Viewers determine a benefit value for each parcel within the watershed. The parcel benefit value is used to calculate a percent of total benefits. These percentages are then used to determine how much each parcel pays for repairs and maintenance on the County drainage system.

The Viewers will explain the viewing process and listen to any concerns. Landowners are encouraged to attend.



Viewers

Mark Behrends	507-383-6364
Bob Hansen	507-383-6288
Kendall Langseth	507-391-3438
John Thompson	507-525-4659

**Note:** Because of privacy laws, the Ditch Viewers are unable to obtain information regarding land enrolled in government programs. This documentation is asked to be provided by the landowners. If you have land enrolled in a **permanent** government program such as WRP, CREP, RIM, EWP, or WREP, please contact us to provide this documentation. **(This may save you some money) (CRP acres do not qualify)** This also refers to any unique drainage situations.

# FARIBAULT JUDICIAL DITCH NO. 13F (JD13F) BRANCH B

## Legend

-  Ditch Viewer Basins
-  Public Open Ditch
-  Public Tile
-  Parcels

Disclaimer: Faribault County does not warrant or guarantee accuracy of the GIS data. The data is meant for reference purposes only and should not be used for official decisions. The data contained in the maps were compiled from the best available records that could be found and may contain errors or omissions.

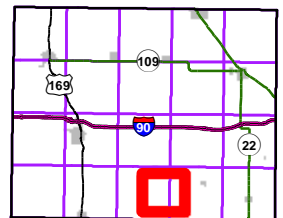

1 inch = 2,875 feet

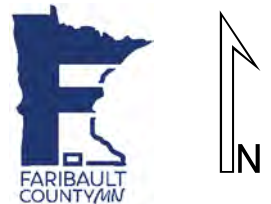

[www.co.faribault.mn.us](http://www.co.faribault.mn.us)

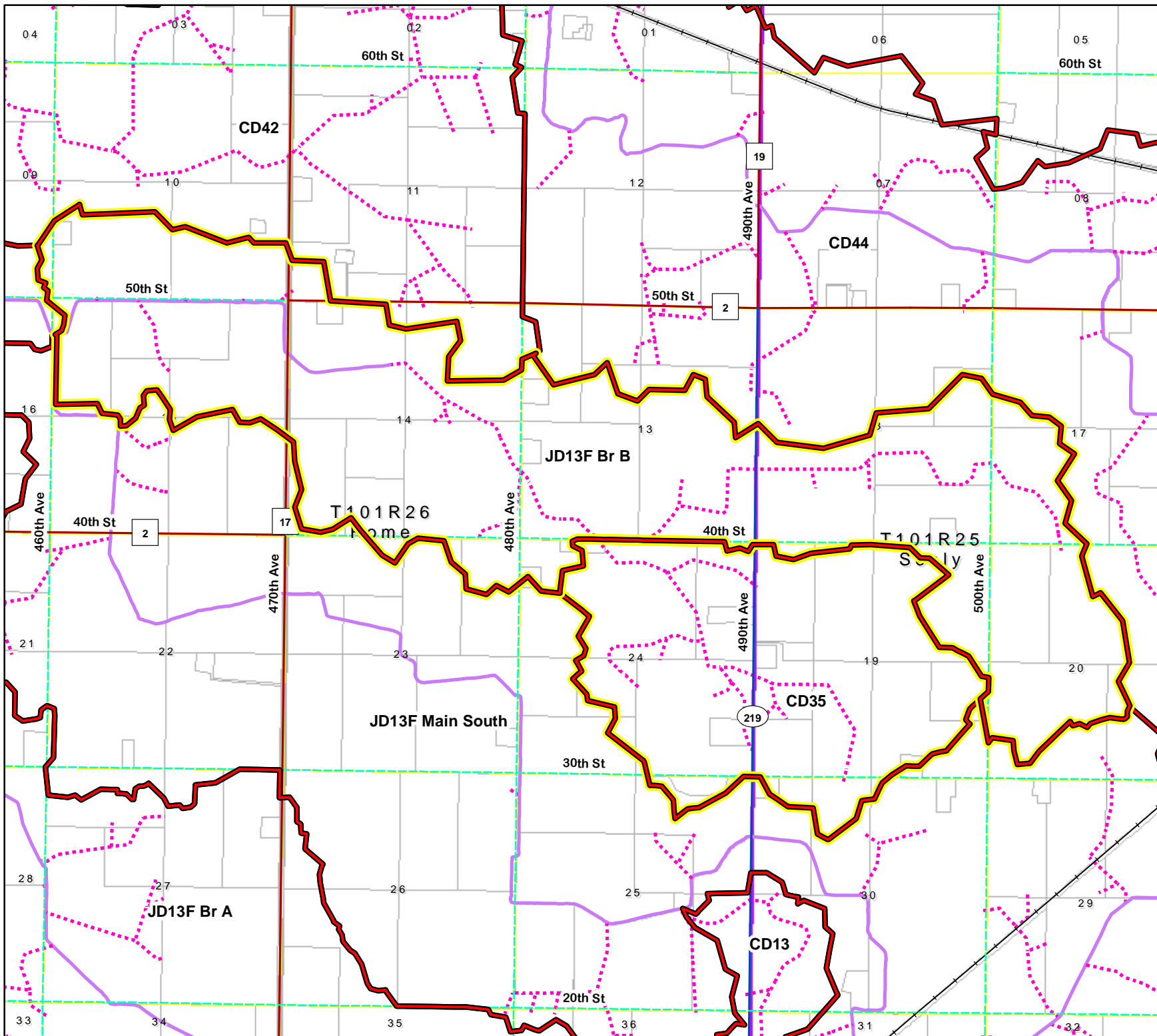

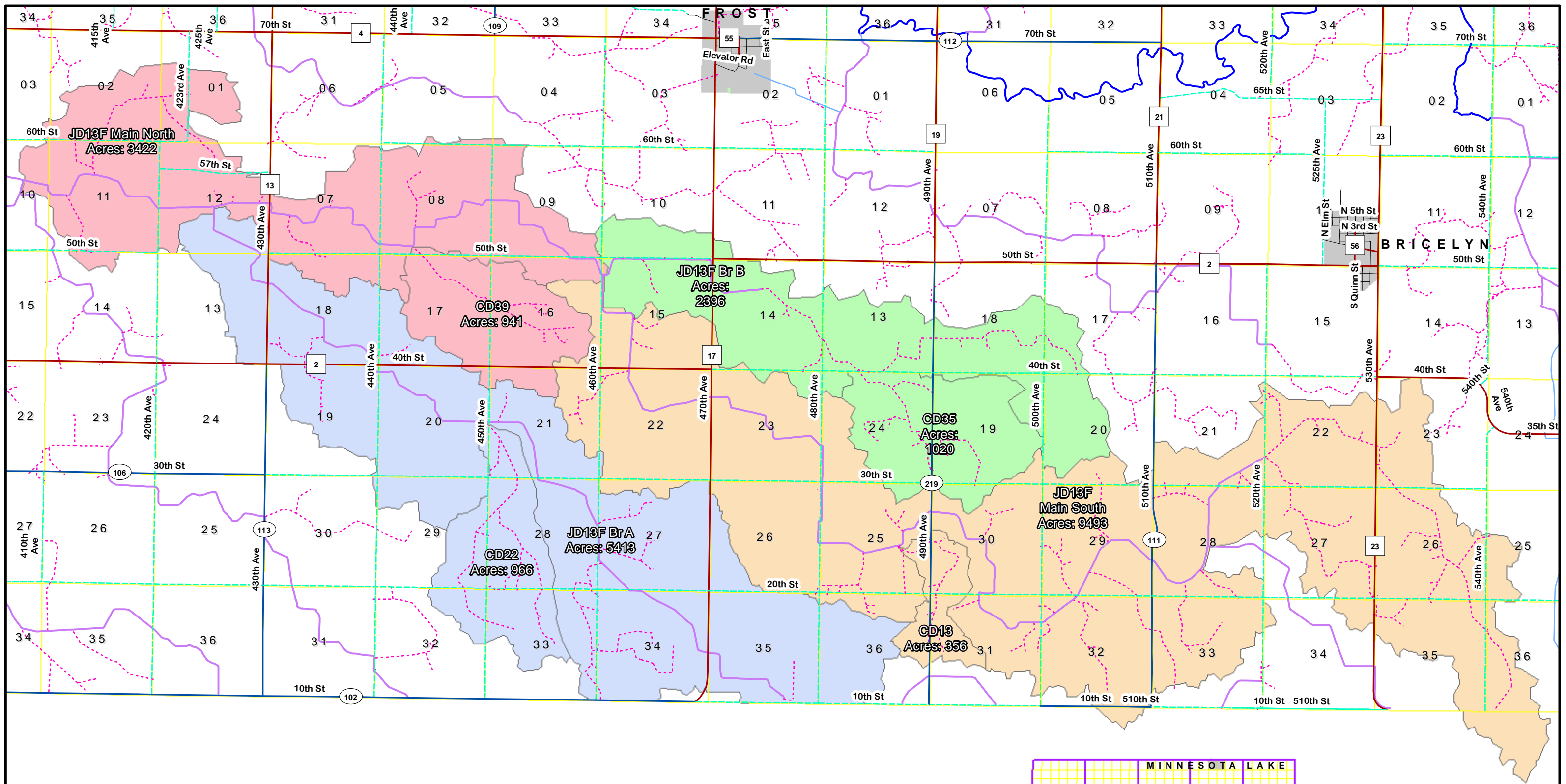

### Legend

#### JD13F Watershed Divide

- JD13F Main North + CD39
- JD13F Main South + CD13
- JD13F Br A + CD22
- JD13F Br B + CD35

- Public Open Ditch
- Public Tile
- Public Watercourse
- River or Stream

## Faribault County Judicial Ditch 13F (JD13F) Watershed Divide

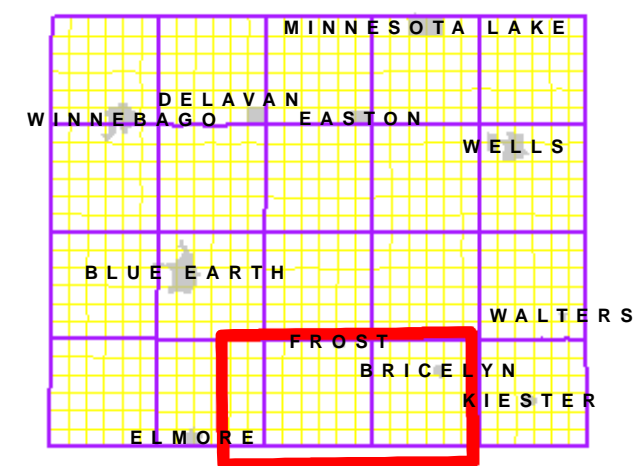

1 inch = 4,500 feet

Disclaimer: Faribault County does not warrant or guarantee accuracy of the GIS data. The data is meant for reference purposes only and should not be used for official decisions.