



# County of Faribault

## Drainage Department

### FARIBAULT COUNTY DITCHES #13, 22, 35, & 39 & JUDICIAL DITCH #13 HEARING NOTIFICATION

June 14<sup>th</sup>, 2023

System: Faribault County Ditches #13, 22, 35, 39, & Judicial Ditch #13  
Location: Elmore Township Sections 1-3, 10-14;  
Rome Township Sections 4-5, 7-11, 13-29, 32-36;  
Seely Township Sections 17-23, 25-36

RE: Division, Consolidation and Redetermination of Benefits and Damages Final Hearings

Dear Landowner:

There will be hearings held on the division, consolidation and redetermination of benefits and damages on Faribault County Ditches #13, 22, 35, and 39 (CD13, CD22, CD35, CD39) and Judicial Ditch #13 (JD13F) held on **Tuesday, July 11<sup>th</sup>, 2023, at 1:30 pm at the Board Room at the Faribault County Courthouse** (415 North Main Street Blue Earth, MN 56013). Redetermination of benefits were ordered for CD13, CD22, CD35, and CD39 on July 21<sup>st</sup>, 2020 and JD13F on March 2<sup>nd</sup>, 2021, due to the benefits not reflecting reasonable present-day land values and change in the benefited area. JD13F is a very large watershed with smaller watersheds within it (CD13, CD22, CD35, and CD39) and also provides an outlet for other public drainage systems. For efficient administration and maintenance of the system and fair and equitable outlet benefits, the Drainage Authority passed a resolution on May 16<sup>th</sup>, 2023, of intent to divide and consolidate the systems. The JD13F system is proposed to be divided into 4 systems and consolidating CD13, CD22, CD35, and CD39 into the divided portions of JD13F (see enclosed map). This meeting will cover the proposed division and consolidations and benefit and damage values. The proposed divisions and consolidations and the Viewers' Reports can be viewed at the Faribault County Auditor's Office or online at <https://www.co.faribault.mn.us/drainage/pages/notices-reports>. **See enclosed public notice for more information on the proceeding.**

Landowners can join this meeting 1 of the following 3 ways.

1. In person at the Faribault County Courthouse Board Room (415 North Main Street Blue Earth, MN) **\*Map on Back**
2. By phone/call-in
3. By Zoom (internet meeting)

If you would like to join the meeting via Zoom you will need a computer, internet, microphone, and speakers. If you do not have a microphone built into your computer, you can call in as well to be able to hear and talk. **If you would like to join via Zoom and/or phone/call-in, please contact the Drainage Department by phone 507-526-2388 or email [linda.adams@co.faribault.mn.us](mailto:linda.adams@co.faribault.mn.us) by July 10<sup>th</sup>, 2023, for information needed.**

At the public hearing, the Viewers will present information about the redetermination of benefits and damages and the Drainage Authority will accept public comment regarding the division, consolidations and/or Viewers Reports. If you have questions or concerns, please contact the Faribault County Drainage Department at the office 507-526-2388 or by email [merissa.lore@co.faribault.mn.us](mailto:merissa.lore@co.faribault.mn.us).

Sincerely,

Merissa Lore  
Drainage Manager

#### Board of Commissioners/ Drainage Authority

Drainage Staff  
415 S. Grove St., Suite 8  
Blue Earth, MN 56013  
(507) 526-2388  
Fax: (507) 526-2508

District 1:  
John Roper  
18 Elm Blvd.  
Blue Earth, MN 56013  
(507) 526-2710

District 2:  
Greg Young  
35719 150<sup>th</sup> St.  
Winnebago, MN 56098  
(507) 526-3420

District 3:  
Bill Groskreutz, Jr.  
36 4<sup>th</sup> Ave. SW  
Wells, MN 56097  
(507) 553-3518

District 4:  
Tom Loveall  
39290 200<sup>th</sup> St.  
Winnebago, MN 56098  
(507) 854-3300

District 5:  
Bruce Anderson  
50156 110<sup>th</sup> St.  
Bricelyn, MN 56014  
(507) 993-4934

Darren Esser  
Auditor/Treasurer/Coordinator  
415 North Main St.  
Blue Earth, MN 56013  
(507) 526-6211  
[www.co.faribault.mn.us](http://www.co.faribault.mn.us)

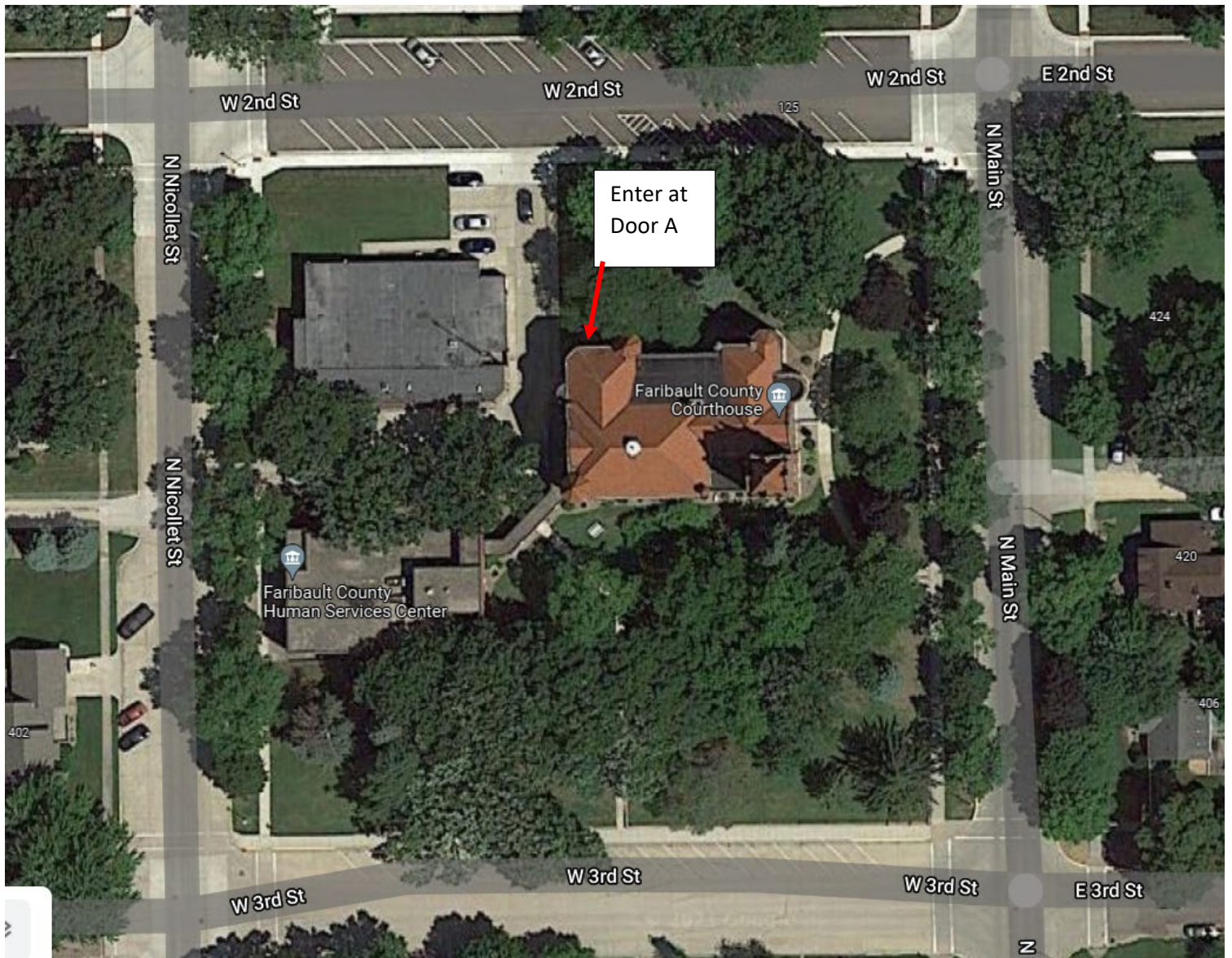

Enter through Door A off of West 2<sup>nd</sup> Street. The Board room is up the stairs, 1<sup>st</sup> door on the left-hand side. If you need an elevator turn right after entering door A. The elevator is done the ramp and on the right.

**STATE OF MINNESOTA**  
*Before the*  
**FARIBAULT COUNTY BOARD OF COMMISSIONERS**  
**SITTING AS THE DRAINAGE AUTHORITY FOR**  
**JUDICIAL DITCH #13 AND COUNTY DITCHES #13, 22, 35, AND 39**

---

**In the Matter of:**

**Division and Consolidation and  
Redetermination of Benefits and  
Damages of Judicial Ditch #13 and  
County Ditches #13, 22, 35, and 39**

**FINAL HEARING NOTICE**

---

PLEASE TAKE NOTICE, the Faribault County Board of Commissioners, sitting as the drainage authority for Judicial Ditch #13 and County Ditches #13, 22, 35, and 39 will hold a final hearing on the division of Judicial Ditch #13 and consolidation and redetermination of benefits and damages of Judicial Ditch #13 and County Ditches #13, 22, 35, and 39. Judicial Ditch #13 is proposed to be divided into 4 systems and consolidating County Ditches #13, 22, 35, and 39 into the divided portions of Judicial Ditch #13 for efficient administration of the systems and fair and equitable outlet benefits. The Viewers' Reports were filed with the drainage authority on May 30<sup>th</sup>, 2023, and are available for inspection at the Faribault County Auditor's Office, 415 North Main Street, Blue Earth, MN. The hearing shall be held **at 1:30 p.m. on July 11<sup>th</sup>, 2023, at the Faribault County Board Room on the middle level of the courthouse building located at 415 North Main Street, Blue Earth, MN.** The hearing can be attended virtually via phone or computer. Contact the Faribault County Drainage Department at 507-526-2388 for more information on virtual attendance. At the hearings, the drainage authority will accept public comment regarding the division and consolidation of the systems and the Viewers' Reports. Any party having an interest in the proceedings may appear and provide comment. Written comments will be accepted at the hearing and by mail through the date of the hearing at the Faribault County Auditor's Office, PO Box 130, Blue Earth, MN 56013.

Judicial Ditch #13 consists of several branches of open ditch and tile lines and provides an outlet to several other public drainage systems including County Ditches # 13, 22, 35, 39, 78, and 102 and Winnebago County, Iowa Drainage Districts #64 and 102. County Ditches #13, 22, 35, and 39 consist of several tile branches.

The following properties are affected by the division, consolidation and Viewers' Reports of benefits and damages:

Elmore Township, T 101N-R 27W, Sections: 1, 2, 3, 10, 11, 12, 13, 14;

Rome Township, T 101N-R26W, Sections: 4, 5, 7, 8, 9, 10, 11, 13, 14, 15, 16, 17, 18, 19, 20, 21, 22, 23, 24, 25, 26, 27, 32, 33, 34, 35, 36;

Seely Township, T 101N-R25W, Sections: 17, 18, 19, 20, 21, 22, 23, 25, 26, 27, 28, 29, 30, 31, 32, 33, 34, 35, 36;

All in Faribault County.

The following owners of property are affected by in the division, consolidation, and Viewers' Report of benefits and damages:

Abraham, Joan Etal; Alspaugh, Dana B Etal; Amundson, D J L Inc; Anderson, Darren G; Anderson, Edna M Trust Etal Mark Anderson Trustee; Anderson, Mark A; Anderson, Mark Etal; Anderson, David C; Anderson, Gene R; Anderson, Mary Jane Gary A Estebo; Anna Mae Nodland Trust C/O Jeff Nodland; Asmus Family Ltd Partnership %Harlan H Asmus; Asmus Family Ltd Partnership & Harlan H Asmus; Asmus, Harlan & Amy; Baker, Wayne; Baker, Nancy; Becker, Gloria A & Jerry A Life Estate Etal; Benjamin, Peggy; Berkeland, Jeffrey & Mary Berkeland Revocable Trust; Bethany Evang Luth Cemetery Assn C/O Wayne Baker; Bethany Evangelical Lutheran Church; Betty J Fenske Revocable Trust; Beyer, Jordan T Abigail R Beyer; Bleess, Audrey; Blom, Paul B & Marsha K; Boehm, Duane; Boettcher, Robert; Boettcher, Vernon W Life Estate Etal; Boggero Family Irrevoc Trust Deborah I Tolton Trustee % Antonio & Charlotte Boggero; Bromeland, Duane D & Alice L; Bruce Peterson Living Trust & Connie Peterson; Bungert, James P & Heidi J; Canterbury, David; CCS Family Farm Llc C/O Cordell B Satre; Cochran, Ronald P & Gelene P Revocable Trust; Columbus, Barbara; Courier, Gary & Dorothy; D J L Amundson Inc; Dahl, Eric D; Davids, Duane A & Julie A; Dean Johnson Et Al & Dean Johnson Revoc Trust; Dean M Johnson Revocable Trust; Dean Oswald Life Est Et Al C/O John Oswald; Donnis Mathews Trust; Eajer Inc; Eckhart, Joel J Rlt & Sheryl Eckhart Rlt; Eckhart, Sheryl L Rev Liv Tr & David A Klatt; Ehrich Family LP, Gary & Sandra; Ehrich, Duane & Joyce F; Ehrich, Duane Etal; Ehrich, Gary; Ehrich, Gary & Sandra; Ehrich, Shawn & Mary; Ehrich, Shawn; Eilertson, Jerald S Family Tr; Eilertson, Kieth J Rev Trust & Carolyn J Eilertson Rev Trust; Eilertson, Mardelle J; Emmers, Michael Wayne Mandy Lynn Emmers; Engebretson, Lloyd & Linda; Ennen, Benjamin J; Erdahl, Barbara L C/O Lisa Erdahl; Eugene Nodland Trust C/O Jeff Nodland; Evans, Mary L & Duane A; Fenske, Jeanette A & Wayne D Fenske Family Trust; Fenske, Larry; Fenske, Todd; Flo Farms Llc; Flo, David J & Julie A; Frandle, Gerald Trust Created Ardys Frandle Trustee Art Vii Last Will & Testament C/O Steven Frandle; Frandle, Glen A & Ardell Frandle; Frandle, Mark & Lynn; Frandle, Steven & Barbara; Frandle, Ardys C/O Steven Frandle; Frandle, Ardys Gerald Frandle Trust % Steven Frandle; Fred C Krahmer Rev Tr Etal; Fredrickson, Ruth Louise A Williamson; Fretty, Beverly M Rev Trust; Gard, Anthony Life Estate Etal; Gerald Frandle Trust Ardys Frandle Trustee C/O Steven Frandle; Gesche, Steven C/O Custom Built Pneumatics Inc.; Gesche, Gregg R & Mary K Gesche Trust; Gesche, Rebecca A; Gesche, Steven L; Giardini, Violet & Timothy R Sweet; Goette, Carolee Revocable Trust; Goette, David T & Amy M; Goette, Jerald; Gray, Robert J Etal C/O Frederick Gray; Grayson, Kathleen Brand Trust C/O Farmers National Company; Grimmelman, Rodger; Gudal, Susan; Gudal, Timothy & Susan; Gudal, Timothy P; Gustafson, Jo Hawlish; Hansen, Cory T Trish A Matter; Hanson, Brice & Lacey; Hanson, Brice A; Hanson, Robert; Hanson, Janie L; Hantelman, Kristi

L; Hartman, Gene L; Helegson, Diane Revocable Trust C/O Northwestern Farm Mngmnt; Helgeson, Ann; Hendrickson, Henrik Family Trus Ruth Hendrickson, Trustee; Hill, Clay C; Hill, Harold J & Mary L Living Trust Et Al C/O Steve Lawrence; Hogstad, Ronald Rev Living Tr & Mary L Hogstad Rev Living Tr; Holland, Edwin R; Holland, Thomas, Marital Trust C/O Brian M Holland; Hougen, Blaine & Samatha Hougen; Hove, David Allen & Ingrid Elisabeth Hove; Hove, Paul E Et Al; Hove, Lorraine M; Hovland, Bruce; Huber Jr, Charles Patricia A Huber; Huber, Charles E; Huber, Charles Et Al; Huber, Eldon L; Huber, Gene R; Huber, Russell Revocable Tr & Barbara Huber Revocable Trust; Huper, Steven L & Kimberly K; Huper, Willard E Rev Trust; Jacobson, Alton T; Jacobson, Ann L; Jacobson, Larry & Beth; Jacobson, Larry Etal; Jahnke, Devon; John A Bromeland Etal C/O Bill Bromeland; Johnson Pork Producers Llc; Johnson, Anthony & Miranda K; Johnson, Paula A Trust Etal %Donald & Paula Johnson; Johnson, Ricky Kathleen Purdie; Johnson, Dean; Johnson, Dennis & Darius; Johnson, Harris D Ruby A Johnson Trust, Ruby A Johnson Trustee; Johnson, Lucas J; Johnson, Nickolaus & Amanda; Kark Family Farms Llp C/O Farmers National Co # 16473; Knutsen, Patricia; Kolstad, Edward P & Pamela J Life Estate Etal; Krahmer, Fred C Rev Tr Etal; Krahmer, Fred C Rev Tr Etal Cheryl M Krahmer Trust; Kuchenbecker, Kenneth & Sara; Langford, Chance; Langsev, Wade E Etal; Langsev, Lawrence & Edith; Larsen, Twyla; Legred Land & Ag Invstmnts Llc; Legred, Joel Et Al C/O Kevin Legred; Legried, Buckey D Fam Inc Trust C/O Scott R Legried Trustee; Legried, Scott; Leland, Craig G Lesa Dahl-Leland; Leland, Douglas B & Lisa M; Leland, Trevor; Leland, Trevor B & Emily M; Leland, Trevor Emily (Leland) Krohnberg; Lium, Gary Etal; Madetzke Enterprises Llc; Madigan, Marsha K & Scott H; Martin, Dorothy; Mccabe, Patricia A Disc Trust & D J L Amundson Inc; Mccabe, Patricia A Disc Trust & Joshua D Amundson; Mehl, Judith L; Mellesmoen, John; Mensing, Mark And Irene Le Etal; Merwin, Andrey Alicia Merwin; Molskness, Gerald L; Morris R Blom Revocable Tr & Teresa E H Blom Revocable Tr; Musel, Shannon C; Nave, Daniel Douglas Rebecca Kay Nave; Nelson Farms Of Blue Earth; Nelson, Cynthia R & Gregory; Nelson, Julia Mcallister Life Estate Etal C/O Nancy Dornfeld; Nelson, Paul R Etal; Nodland, Eugene Trust C/O Jeff Nodland; Nodland, Jeffrey M; Norland, Beverly C/O Brownlee Management Inc; Olson, Orin J Rev Trust C/O Tara Crubaugh; Osland, Rick O; Oswald, Dean Life Estate Etal; Oswald, Randall D Rlt & Susan M Oswald Rev Liv Trust; Oswald, Dean & Theodora C/O John Oswald; Oswald, Dean & Theodora Family Partnership; Paape, Karen D Revocable Trust; Patricia A Mccabe Disc Tr Etal C/O David Amundson; Peluso, Anita M; Peterson, Nancy Lee & Dion; Peterson, Jeffrey & Staci; Pratt, Mary Et Al; Prestegard Fam Ltd Partnership C/O Allen Prestegard; Prestegard, Allen & Judith Richard & Brooke Prestegard; Prestegard, Allen O & Judith A; Prestegard, Richard A Brooke E Prestegard; Prestegard, Allen O & Judith A Floyd W Walton Life Estate; Puhak, Jennifer A Bishop Mardell Faber; Quamme, Bennett Farms Ltd; Randal D Oswald Rlt & Susan M Oswald Rev Lt; Randy M Ennen Revocable Trust; Rieckhoff, Judith K Qtip Trust C/O Capital Ag Prop Serv Inc; Ripley, Janice; Ripley, Kenneth & Sheila; Ripley, Kenneth D Etal; Ripley, Steven R & Janice M; Ruth Elaine Fredrickson Tr & Louise A Williamson; Sabin, Noel D & Destiny M; Sabin, William C; Sahr, Brandon & Jasmine A; Satre, David I & Colleen; Satre, Roger D; Satre, Roger D & Kathryn; Schaefer, Fran Revocable Trust Fran & Roger Schaefer Trustees; Schonborn, Brian & Amy; Silrum Revocable Trust U/A % Daryl H Silrum; Solis, Lorenzo Fernando; Spencer, Andrea Etal; Sylvara, Kurt L; Tandberg, Pamela A; Teems, Taylor Cali Teems; Teig, Danny O; Teigland, John B & Mary A Janice E & Donald B Smith; Tenhassen Farms Inc; Tenneson, Grace L Life Estate & Arthur Tenneson; The French Family Trust L C & E C French Co-Trustees; Thompson, Gloria J Le Etal & Charles W Thompson Le Etal; Thompson, John L & Charlene K; Timothy J Tusha Sif-Drctd Ira C/O First Citz Bnk Trust Dept; Trust Agrmt Of Gerald L Sonnek; Twedt, Joshua; Twedt, Larry & Barbara A; Twedt, Micah; Underdahl, Chris A; Walton, Floyd W Life Estate & Mitchell D Walton Etal; Warner, Stephen M & Nancy M & Williams Family Partnership Ii; Weber, Barron K; Wertjes Family Trust J C Wertjes & D C Meyer Co-Trs; Wertjes, Joanne C; Willette, Jason; Williams Family Partnership II C/O August Williams; Wilson, Robert D; Wolff Farms Llc.



The following governmental entities are affected by the division, consolidation, and redetermination of benefits and damages of Judicial Ditch #13 and County Ditches #13, 22, 35, and 39:

Elmore Township, Faribault County; Faribault County; Rome Township, Faribault County; Seely Township, Faribault County.

The proposed divisions and consolidations and the Viewers' Report and Property Owners' Report for each system can be obtained by calling the Faribault County Auditor's Office at 507-526-6211 or may be found online at <https://www.co.faribault.mn.us/drainage>.

---

County Auditor-Treasurer-Coordinator

Dated: June 14<sup>th</sup>, 2023

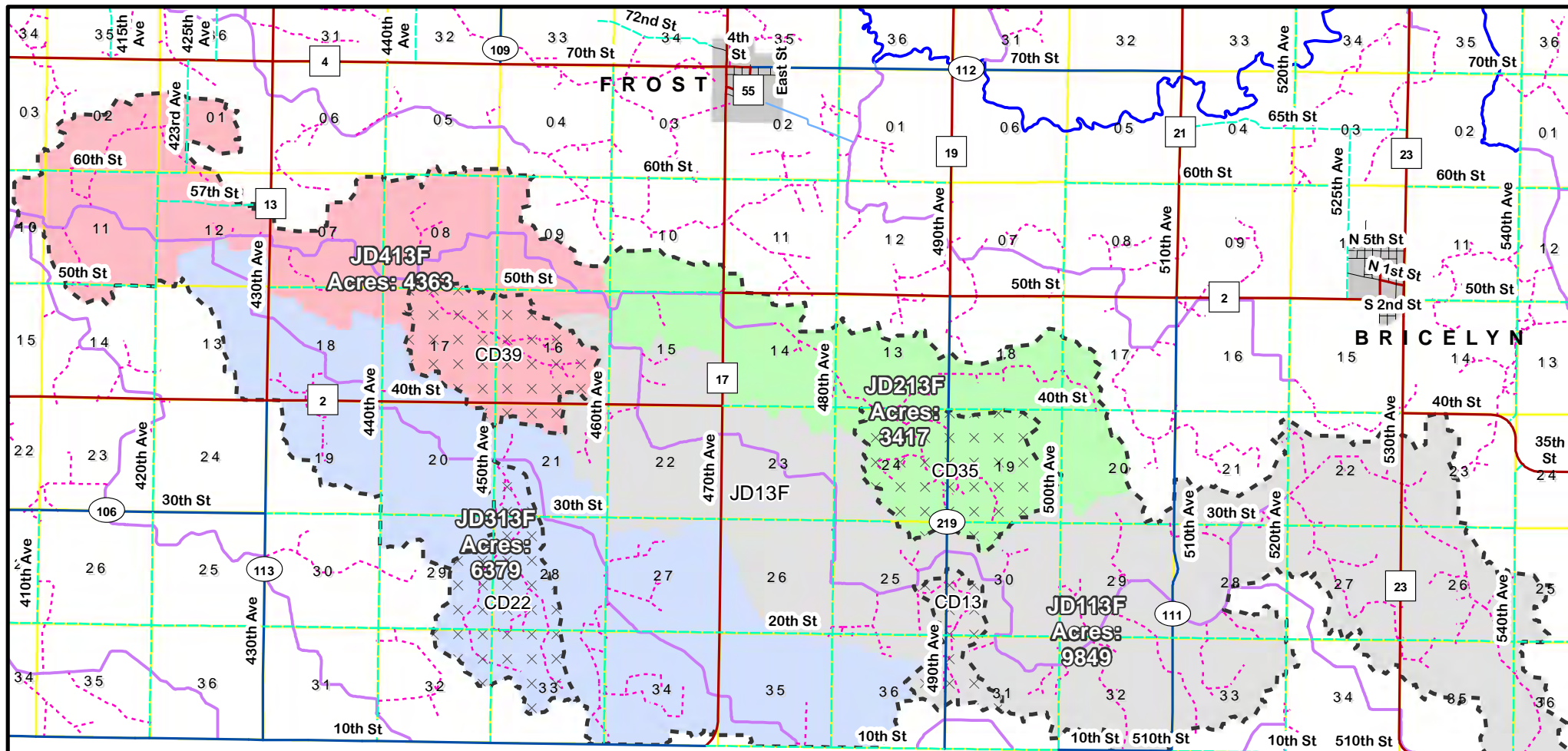

Faribault County

CD13, CD22, CD35 & CD39 Consolidation & JD13F Division

### Legend

CD 13 Watershed Before Consolidation & Division

× × × Consolidated System

### Watershed After Consolidation & Division

- |        |                    |
|--------|--------------------|
| JD113F | Public Open Ditch  |
| JD213F | Public Tile        |
| JD313F | Public Watercourse |
| JD413F | River or Stream    |

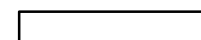
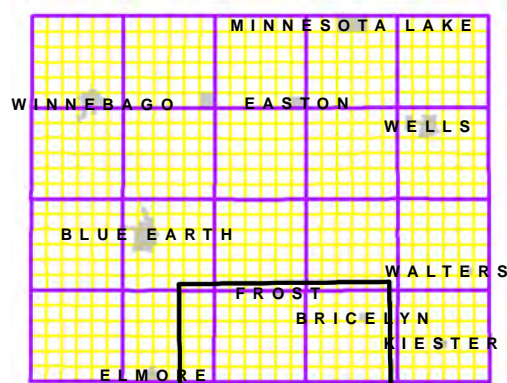

1 inch = 6,875 feet

Disclaimer: Faribault County does not warrant or guarantee accuracy of the GIS data. The data is meant for reference purposes only and should not be used for official decisions.